



BYLAW NO. 08.15

To Establish the boundaries for the Hamlet of Brule, Alberta

WHEREAS, Section 59 of the Municipal Government Act Being Chapter M-26, R.S.A. 2000 empowers Council to declare any given area to be a Hamlet and to designate its boundaries;

AND WHEREAS, it is deemed desirable to declare the area to be a Hamlet and to designate its boundaries;

NOW THEREFORE, the Yellowhead County Council, in the Province of Alberta, duly assembled, hereby enacts as follows:

1. The boundaries of the Hamlet of Brule shall be established as outlined in red on Schedule "A".
2. The lands described in Schedule "B" shall be declared as the Hamlet of Brule, Alberta.
3. This bylaw comes into force at the beginning of the day that it is passed in accordance with Section 189 of the Municipal Government Act, Being Chapter M-26, R.S.A., 2000.
4. Bylaw 01.86 is hereby repealed.

READ a first time this 8th Day of September A.D., 2015.

READ a second time this 8th Day of September A.D., 2015.

READ a third time this 8th Day of September A.D., 2015.

SIGNED this 8th Day of September A.D., 2015.



Mayor Gerald Soroka



Chief Administrative Officer, Jack Ramme

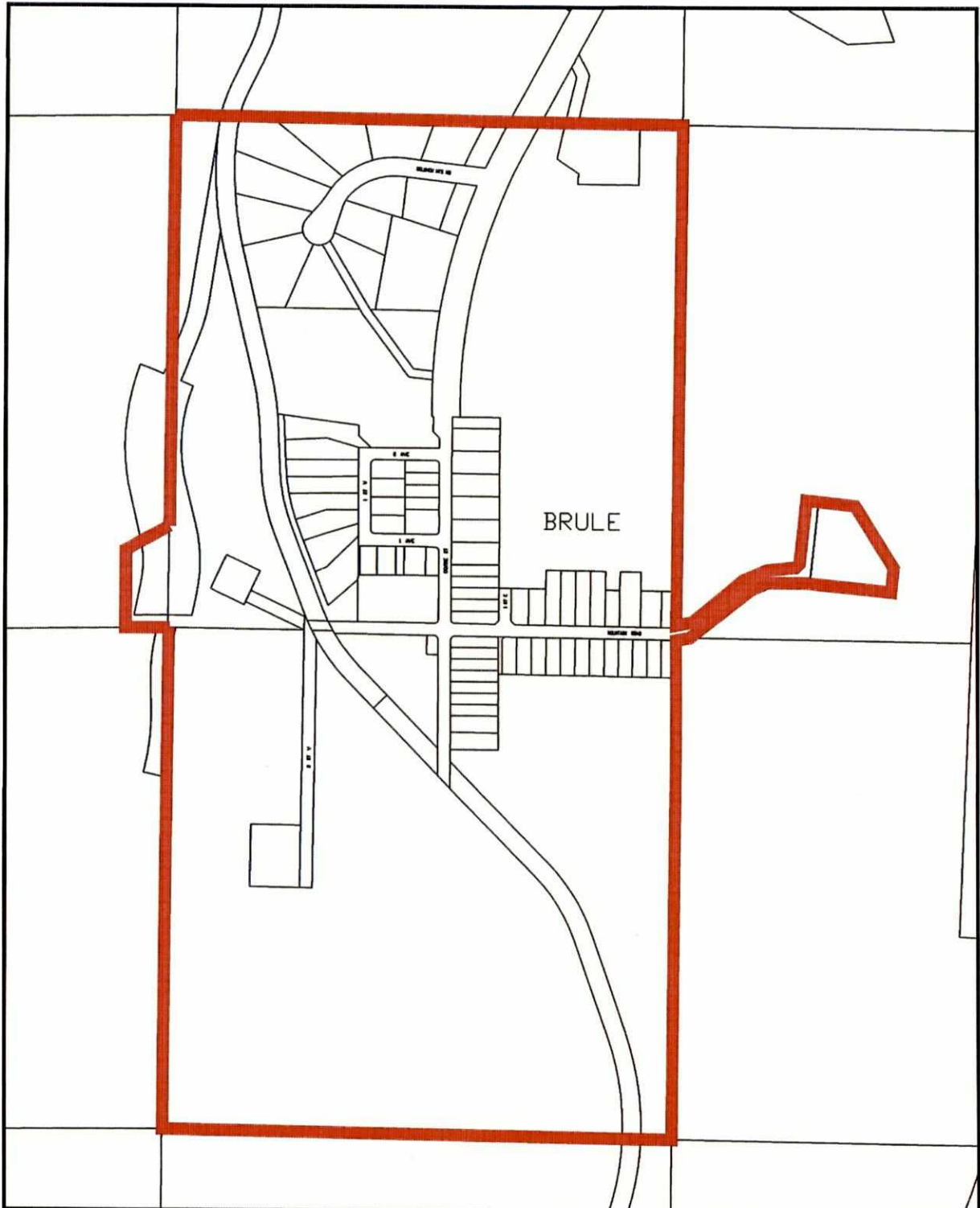

TITLE:
HAMLET OF BRULE (BYLAW No. 08.15)
YELLOWHEAD COUNTY
SCHEDULE "A"

HAMLET BOUNDARY	
SCALE: N.T.S.	
DATE: MARCH 2015	
STD. DWG NO.	D-04

BYLAW NO. 08.15

SCHEDULE "B":

All lands and roads within:

- Northwest quarter of Section ten (10), Township Fifty (50), Range Twenty – Seven (27), West of the Fifth(5) Meridian
- Southwest quarter of Section Fifteen (15) , Township Fifty (50), Range Twenty –Seven (27), West of the Fifth(5) Meridian
- all lands identified as Lot B in Plan 1939 RS and the part of Mountain Road contained therein as show on Registered Plan 1939RS within the Southeast quarter of Section Fifteen (15), Township Fifty (50), Range Twenty-Seven (27), West of the Fifth (5) Meridian.
- License of Occupation 830635 in Southeast quarter of Section Sixteen (16), Township Fifty (50), Range Twenty-Seven (27), West of the Fifth (5) Meridian.